



Supplementary Owner's Handbook
Ford **Transit** 8/9 Seat Minibus
February 2007 on



The illustrations, technical information, data and descriptions contained in this publication, were correct at the time of going to print. VFS (Southampton) Ltd reserve the right to make any changes necessary in line with continuous development and improvement.

No liability can be accepted for any inaccuracies or omissions in this publication, although due care has been taken to make it as complete and accurate as possible. This publication describes options and trim levels available throughout the Ford Transit 8/9 Seat Bus model range, and therefore some of the items covered may not be available or apply to your vehicle.

This publication may not be duplicated, reprinted, stored in a data processing system or transmitted by electronic, mechanical, photographic or other means, or recorded, translated, edited, abridged or expanded without the prior written consent of VFS (Southampton) Ltd.
The same also applies for parts of this manual and their use in other publications.

© Copyright 2006. Issued by VFS (Southampton) Ltd. Part No: VFS01-16-062A

Printed by: Bob Watkins Artwork & Design 01708 222322. Printed on totally Chlorine-free (TCF) paper

Table of Contents

Introduction	3	Seats	19
		Cab seats	
Legal Requirements	4	Rear Passenger seats	
Tachograph			
		Luggage	21
Vehicle Layout	5	Emergency Equipment	22
		Information & Warning Decals	23
Doors	6	Maintenance	24
Overview		Vehicle Identification	25
Opening sliding doors		Technical Specifications	26
Occupant Protection	7	Wiring Diagrams	27
General references		Luggage compartment Illumination	
Rear compartment seating		Stepwell Illumination	
Locks	8	Spare Parts	29
Locking the vehicle		Parts supply	
Unlocking the vehicle		Parts Lists	
		Parts listing by category including diagrams	
Alarm	12	Warranty	39
Arming the perimeter alarm		Index	40
Triggering the perimeter alarm		Maintenance & Repair Log	42
Disarming the perimeter alarm			
Lighting	14		
Stepwell illumination			
Luggage compartment illumination			
Climate Control	16		

Introduction

This supplementary owners handbook must be referred to in addition to the standard Transit owners handbook. Read and understand both manuals and familiarise yourself with the vehicle before operating the vehicle on the road.

Note: This manual only details the features on the Transit 9 seat bus that are not covered in the standard Transit owners manual, therefore it is imperative that this manual is kept with the standard Transit owners guide at all times.

Note: Always use and operate your vehicle in line with all applicable laws and regulations.

Note: Pass on this handbook when selling your vehicle, it is an integral part of the vehicle.

SYMBOLS GLOSSARY

Symbols in this handbook

Warning



You risk death or serious injury to yourself and others if you do not follow the instructions highlighted by the warning symbol.

Legal Requirements

The Transit 9 seat minibus complies with all UK vehicle legislation. Before taking the vehicle outside the United Kingdom, local legislation of the destination country and any countries that are travelled through must be checked to ensure compliance.

Tachograph

If it is intended that the vehicle is taken outside of the United Kingdom a tachograph will be required.

For use within the UK a tachograph may be required under certain use conditions defined in 'Drivers Hours and Tachograph Rules for Passenger Vehicles in the UK and Europe' and revisions, copies of which can be obtained from VOSA at the Department for Transport.

Vehicle Layout

Familiarise yourself with the layout of the vehicle, before operating. Knowing the position and control of the entry/exit doors is essential to the safe operation of the vehicle and safety of the passengers. The luggage compartment can only be accessed from the rear of the vehicle.

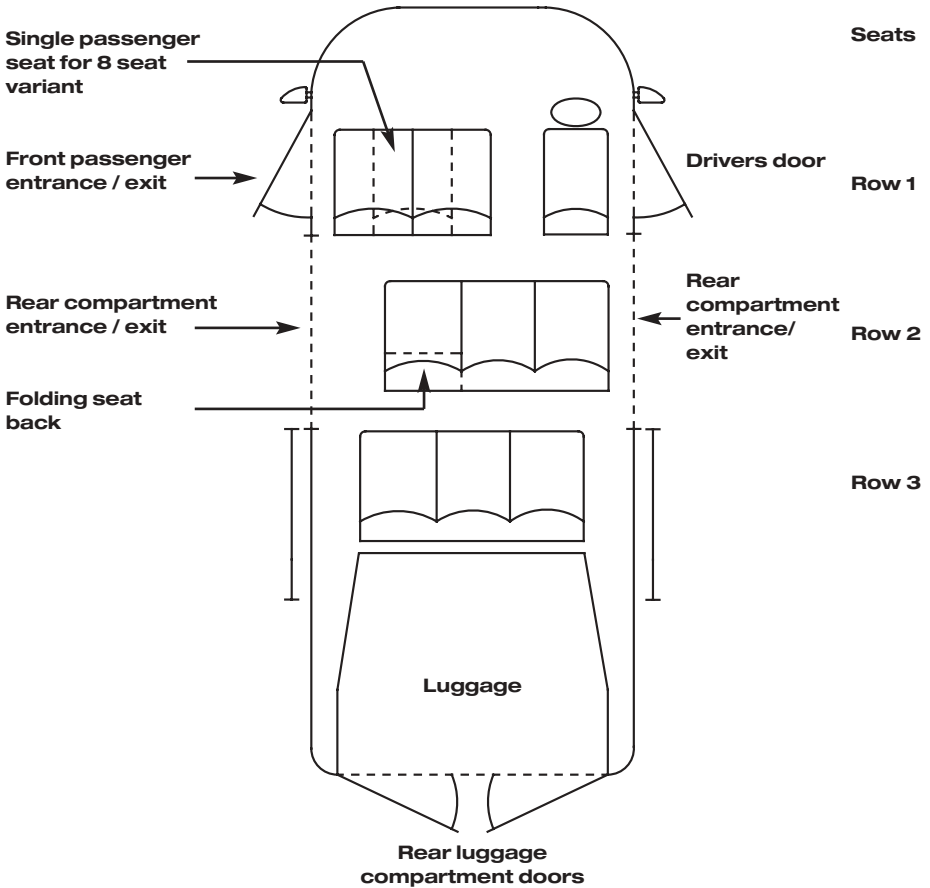

Doors

Opening sliding doors

To open from the inside or from the outside pull the door handle and then slide the door backwards until it engages with the stop.



To manually lock a sliding door, turn the locking knob on the inside of the door to the locked position. To unlock, turn it to the unlocked position.



Warning



Make sure that the roof rack and its load do not obstruct the sliding door. Ask your dealer for advice on roof racks suitable for your vehicle.

Occupant Protection & Child Safety

General requirements:

Refer to Transit owners handbook – 'Occupant protection' and 'Child safety' for details relevant to the cab compartment.

Rear compartment seating:

Refer to Transit owners handbook – 'Occupant protection' and 'Child safety'.

Row 2 – Row 2 is equipped with ISOFIX anchor points – see 'Child safety' in the Transit owners manual for further info. Standard lap and diagonal seat belts are supplied with row 2.

Locks

Please refer to the Transit owner's handbook for details on 'Keys and Remote Controls', 'Alarm', and 'Engine Immobiliser'. The perimeter alarm can be specified as an option on the 9 seat bus, no other alarm options are available.

Locking the vehicle

Type of locks:- Power locking with remote key entry.

Locking the vehicle using the remote control buttons

To lock all the doors on the vehicle, press the 'lock' button on the remote key once. Pressing button twice for double locking.

Warning - Passengers will not be able to exit the vehicle in an emergency if it is double locked

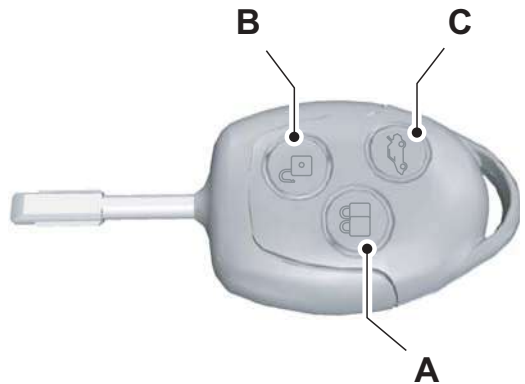

- A Lock
- B Unlock
- C Cargo Lock

Press the lock button **once**.

Locks

Locking the vehicle using the mechanical key

To lock all the doors on the vehicle, turn the key in the lock to position B.

- A Unlock
- B Lock

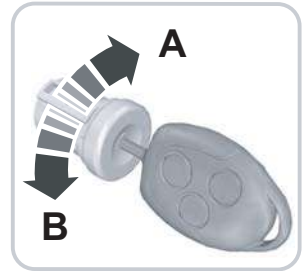

Locking the vehicle using the internal door controls

To lock all the doors on the vehicle, push the driver's or passenger's interior door handle.

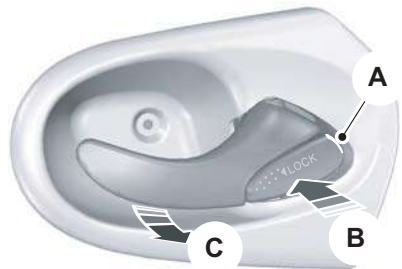

- A White mark
- B Lock
- C Unlock

If you see the white mark the door is locked.

Locks

Visible locking feedback

A locking action is indicated to the user by a single long flash of the direction indicators. Locking feedback is only given once the vehicle is in its most secure locking state. For all vehicles, this is when they are double locked.

If a lock attempt is unsuccessful (e.g. a door is still open), no locking feedback is given.

Audible mislock feedback

If a lock attempt is unsuccessful (e.g. a door is still open), then mislock feedback is indicated to the driver by a short beep of the vehicle horn.

Audible mislock feedback is standard on all vehicles with power locking, but can be disabled or enabled by a Ford dealer.

Locks

Unlocking the vehicle

Unlocking the vehicle using the internal door controls

To unlock the vehicle, pull the driver's or passenger's interior door handle.



- A White mark
- B Lock
- C Unlock

If you see the white mark the door is locked.

It is not possible to unlock the rest of the vehicle from the rear door interior door release.

Unlocking the vehicle using the mechanical key

To unlock the vehicle, turn the key in the lock to position A.

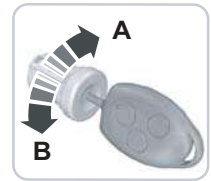

Unlocking the vehicle using the remote control buttons

To unlock the vehicle, press the 'unlock' button. To unlock the rear passenger compartment press the 'cargo unlock' button on the remote key.



Unlocking feedback

An unlocking action is indicated to the user by two flashes of the direction indicators. Unlocking feedback is only given for each unlock action.

Alarm

Perimeter alarm

Perimeter alarm is an optional feature.

The perimeter alarm acts as a deterrent against unauthorised persons opening the cabin, passenger area doors, bonnet or removing the audio system. This is also operational when removing a trailer (if a **Ford** trailer-tow kit is fitted).

Arming the perimeter alarm

The alarm is fully armed by ...

- Centrally locking the vehicle using the lock button on the remote key

The alarm is armed in reduce guard mode by ...

- Centrally locking the vehicle using the key in one of the door locks

- In reduced guard mode, trailer detection is disabled.

Once the vehicle is locked, the 20 second arming delay begins. This allows any open doors or the bonnet to be closed without triggering the alarm. After 20 seconds the alarm arms.

Alarm

Triggering the perimeter alarm

The alarm is triggered when ...

- Any door is opened
- The bonnet is opened
- An attempt is made to start the vehicle without a valid key
- An attempt is made to remove the radio
- A trailer that was connected at the time of arming is disconnected

(not reduced guard)

When the alarm is triggered, the alarm horns sound for 30 seconds and the hazard lights flash for 5 minutes. If the trigger event has been removed, the alarm re-arms. If a trigger event still exists, the alarm horns will sound again.

Disarming the perimeter alarm

The alarm can be disarmed and silenced by...

- Unlocking the vehicle using the unlock button or cargo unlock button on the remote key
- Unlocking the vehicle with the key
- Turning on the ignition with the correct key

Lighting

Stepwell illumination

The vehicle is fitted with stepwell illumination to all passenger doors. The stepwell lamps will come on and go off automatically when you open and close the doors. If you unlock the doors with the remote control, they will illuminate. The lamps will extinguish automatically after a short time.



Sliding
passenger door
LHS



Sliding
passenger door
RHS



Front passenger
door

Lighting

Bulb replacement

Luggage compartment light (10-watt bayonet bulb)

To replace bulb, switch off the interior lights. Prise out the light assembly with a flat-bladed screwdriver. Gently press the bulb into the bulb-holder, turn anti-clockwise and remove the bulb.

Installation is in the reverse order.

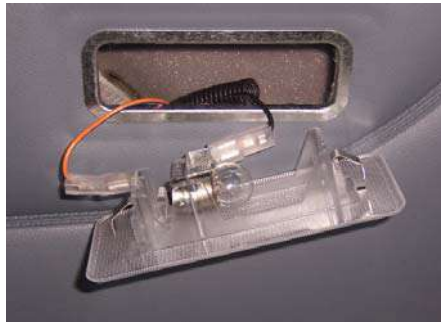

Illuminated stepwell lights (5-watt socket bulb)

To replace bulb, switch off the interior lights. Remove the two cross head screws retaining the lamp assembly to vehicle body. Pull lamp assembly away from the vehicle body. Turn bulb holder and remove from lens, then remove the bulb.

Installation is in the reverse order.



Climate Control

Air conditioning

Switching on the air conditioning.

The air conditioning in the rear passenger compartment will only function if the front passenger compartment air conditioning system is switched on. See Owner's Guide.

Rear heating and ventilation

Controls

The controls for rear heating, ventilation and air conditioning are located centrally in the front passenger compartment headlining.



Climate Control

Air distribution and temperature control

Directs the airflow and temperature as follows.

Face level

The main air stream flows to the upper vents in the rear passenger compartment.



Mix position

The air distribution can be set to any mid position.



Footwell

The main air stream flows to the lower vents in the rear passenger compartment.



Climate Control

Temperature control

Rotate clockwise to increase temperature, anti clockwise to decrease.

Note: The heating effect depends upon the coolant temperature and is therefore only effective when the engine is warm.



Blower

The airflow in the rear of the interior is dependent on the blower.

The blower is off in position 0.

To increase the blower speed, select a higher position.



Rapid heating of vehicle interior

Set the distribution and temperature control to the footwell position.
Select the highest blower setting.



Ventilation

Set the distribution and temperature control. Set the blower to any position. Open the upper vents to suit individual requirements.



Seats

Cab seating

Refer to Transit owners manual for details on cab seats, restraints and child safety. The standard 9 seat bus is fitted with a dual passenger seat as standard. An optional single passenger seat may be specified reducing the total seating capacity to 8 seats.

Rear passenger seats

With reference to the vehicle layout drawing, 6 seats are provided in two rows of seating all fixed:

Row 2 – Triple seat, includes a folding seat back to the nearside seat adjacent to the rear compartment entrance. This feature is operated by a lever to assist entry into the row 3 seating. Pull lever forward whilst simultaneously pushing seat back forward. To return seat back to the upright position simply push back rearwards until it stops.

Row 3 – Full width triple seat. Access from side entrance.



Seats

Load retention

Always position heaviest items directly on the floor.

Use the load lashing points provided on the luggage compartment floor and load barrier to retain luggage securely.

Luggage should be loaded in such a way that no items will be thrown forward, if driver has to brake suddenly.

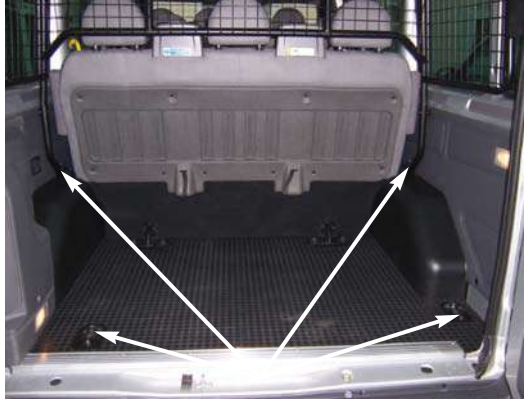

To fold third row seatback to increase rear luggage space

The third row seatback can be folded forward.

To facilitate seatback folding, release straps are located at the back of the seat in the luggage area.

Pull both straps rearward, then push top of rear seat forward to fold.

When raising the seatback, make sure it is locked in the up-right position, listening for audible engagement of latches.



Luggage

Luggage should be stowed and secured in the rear luggage compartment accessible via the rear doors. On no account place luggage in the passenger compartment that may impede the safe entry/exit, therefore luggage should not be placed in seat aisle-ways or by the nearside side entrance/exit door.

Warning



Do not place luggage in the passenger compartment that may impede access to the doors.



Use load securing straps to an approved standard, e.g. Din standard to secure all luggage.



Make sure that you secure all loose items properly.



Place luggage and other loads as low and as far forward as possible within the luggage compartment.



Do not drive with the tailgate or rear door open. Exhaust fumes may enter the vehicle.

Emergency Equipment

First aid kit

First aid kit is located within a sprung loaded bracket on the left hand side of cab locker.

Pull kit upwards to release it from the bracket.

Replace kit after use by pushing back down into bracket until it locks in place.



Fire extinguisher

The fire extinguisher is located on the floor between the driver's and co-driver's seats.

Ensure that the instructions for use, which can be found on the body of the extinguisher, are read prior to it being used.



Information and Warning Decals

Decals are included to assist passengers in operating entrance/exit doors in addition to general information about the passenger capacity, location of first aid and fire extinguishers.

It is important that these decals are maintained in good condition and should be replaced if damaged during normal day to day wear and tear.

List of decals and their location:-

DECAL DESCRIPTION	DECAL LOCATION
NO STANDING	Inside of RH side door, above window.
SEATING CAPACITY 8 PASSENGERS	Inside of RH side door, above window.
PULL TO OPEN (Left Arrow)	Inside of LH side door, adjacent to handle. Outside of RH side door, adjacent to handle.
PULL TO OPEN (Right Arrow)	Inside of RH side door, adjacent to handle. Outside of LH side door, adjacent to handle.
FIRST AID....FIRE EXT....	LH side of instrument panel.
FIRST AID IN OVERCAB LOCKER	Inside luggage compartment on RH body side, and inside passenger compartment LHS
LOCK/UNLOCK (clockwise arrow)	Inside of RH side door, above manual lock control.
LOCK/UNLOCK (anticlockwise arrow)	Inside of LH side door, above manual lock control.
FIRE EXTINGUISHER UNDER FRONT PASSENGER SEAT	Inside rear passenger compartment, rear of RHS sliding door.

Maintenance

In addition to regular servicing of the base vehicle we recommend that you carry out the following checks in addition to those shown in the Transit owners handbook.

Daily checks

- First aid box present and securely located
- Fire extinguisher present and securely located
- Correct operation of sliding doors
- Grab handles (yellow) present and securely located
- Check stepwell lighting
- Check all warning and information decals are present

Monthly Checks

- First aid box contents complete and within date
- Check fire extinguisher condition meter or weight, dependent upon which type fitted. If a meter fitted, ensure it is within the green or OK sector of the gauge, if not replace extinguisher
- Security of seat belt stalks to floor
- Security of passenger compartment seat fixings
- Condition of seat belts, buckles and correct belt retraction
- Smooth operation of both side sliding doors, lubricate with lithium grease if necessary

Vehicle Identification

Vehicle identification plate

The vehicle identification plate is located on the left hand B pillar. This plate displays information on vehicle type, identification number, vehicle weights and additional vehicle data.



Technical Specifications

Tyre pressure

Tyre pressures (cold tyres)						
Tyre size	Payload class	Config.*	Max. axle load (kg)		bar (lbf/in2)	
			front	back	front	back
Bus						
195/70 R15C	8/9 Seat	F, S	1600	1760	4.0 (58)	4.5 (65)
205/65 R16C					3.8 (55)	4.3 (62)

* F = front wheel drive, S = single rear wheel

Dimensions

Dimensions (mm) Vehicles with medium wheelbase		
A = Maximum length	- without rear step	5230
	- with rear step	5340
	- with towing equipment	5380
B = Overall width	(excluding exterior mirrors)	1748
C = Overall height	2 - Semi high roof	2302 – 2379
D = Wheelbase		3300
E = Track	Front	1737 – 1745
	Rear	1700 – 1718

Wiring Diagrams

Luggage illumination

@ [[U[Y W'a dUf'a Ybh'Ua d
@ W'hYX'cb F<'gXY'fja 'dUbY'

@ [[U[Y W'a dUf'a Ybh'Ua d
@ W'hYX'cb @'gXY'fja 'dUbY'

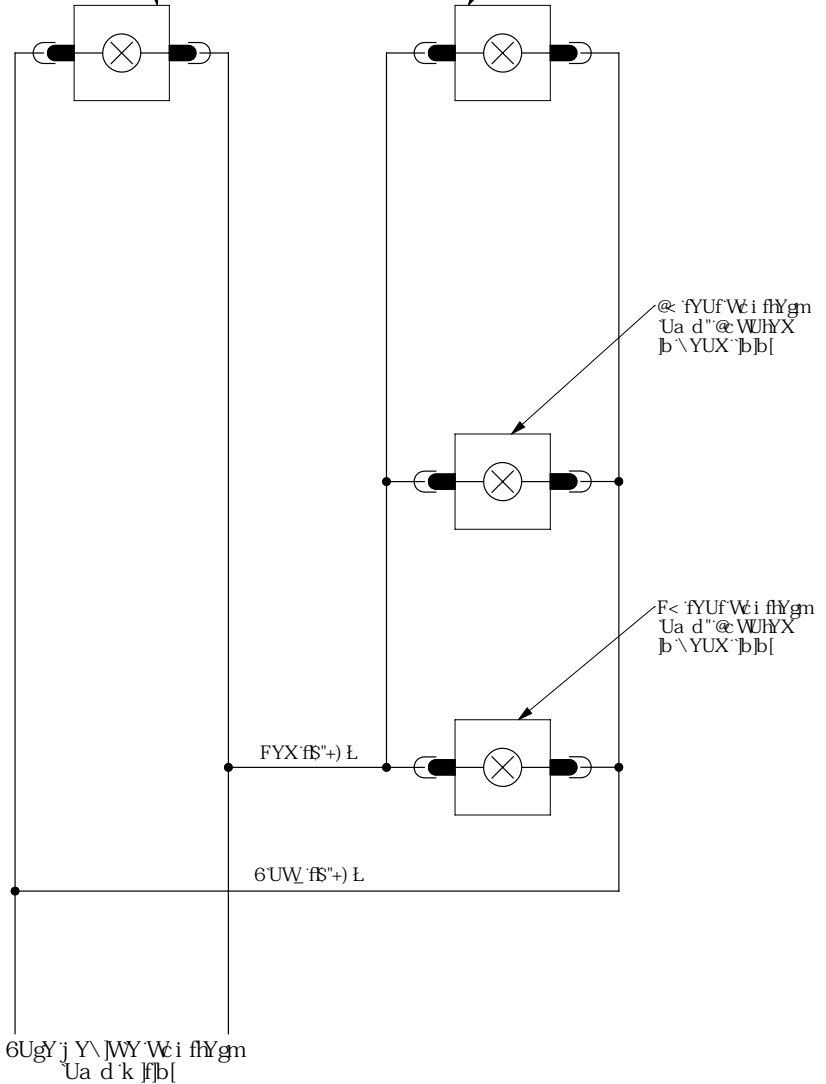

Wiring Diagrams

Stepwell illumination

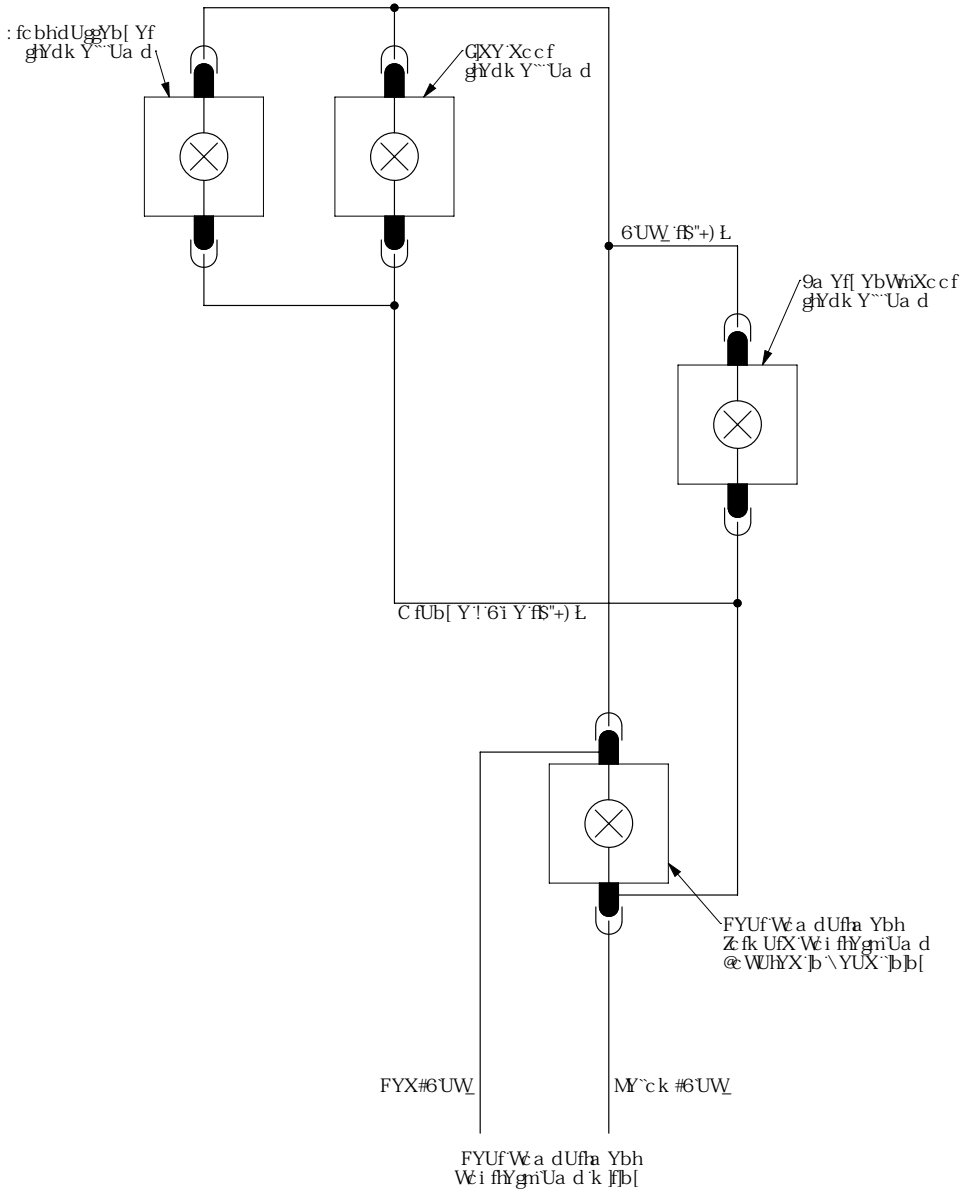

Luggage Area & Associated Parts

This diagram illustrates the assembly of the luggage area, showing the following components and their callout numbers:

- 1: Luggage rack (main frame)
- 2: Luggage rack (side rail)
- 3: Luggage rack (side rail)
- 4: Luggage rack (side rail)
- 5: Luggage rack (side rail)
- 6: Luggage rack (side rail)
- 7: Luggage rack (side rail)
- 8: Luggage rack (side rail)
- 9: Luggage rack (side rail)
- 10: Luggage rack (side rail)
- 11: Luggage rack (side rail)
- 12: Luggage rack (side rail)
- 13: Luggage rack (side rail)
- 14: Luggage rack (side rail)
- 15: Luggage rack (side rail)
- 16: Luggage rack (side rail)
- 17: Luggage rack (side rail)
- 18: Luggage rack (side rail)
- 19: Luggage rack (side rail)
- 20: Luggage rack (side rail)
- 21: Luggage rack (side rail)
- 22: Luggage rack (side rail)
- 23: Luggage rack (side rail)
- 24: Luggage rack (side rail)
- 25: Luggage rack (side rail)
- 26: Luggage rack (side rail)
- 27: Luggage rack (side rail)
- 28: Luggage rack (side rail)
- 29: Luggage rack (side rail)
- 30: Luggage rack (side rail)
- 31: Luggage rack (side rail)
- 32: Luggage rack (side rail)
- 33: Luggage rack (side rail)
- 34: Luggage rack (side rail)
- 35: Luggage rack (side rail)
- 36: Luggage rack (side rail)
- 37: Luggage rack (side rail)
- 38: Luggage rack (side rail)

Spare Parts

ITEM	DESCRIPTION	PART NUMBER	QTY
1	Bulkhead assy - 9 Seat Minibus	VFS01-16-027F	1
2	Roofbow assy - 9 Seat Minibus	VFS01-16-010E	1
3	Spacer load barrier bodyside	VFS01-16-033A	8
4	Guard RH Side Window - 9 Seat Minibus	VFS01-16-034B	1
5	Guard LH Side Window - 9 Seat Minibus	VFS01-16-035B	1
6	Guard RH Rear Window - 9 Seat Minibus	VFS01-16-007G	1
7	Guard LH Rear Window - 9 Seat Minibus	VFS01-16-008G	1
8	Reinforcement - Bulkhead lower RH bodyside C/W speaker cutout	VFS01-16-077A	1
9	Reinforcement - Bulkhead lower LH bodyside C/W speaker cutout	VFS01-16-078A	1
10	Cup - Load Lashing	Ford Part	2
11	Loop - Load Lashing	Ford Part	2
12	Bolt M10 x 70 Socket cap	VFSH02-0023	8
13	Rivet - 6.35 x 16mm (Avdel Hemlok)	VFSH05-0006	6
14	Rivet - 6.35 x 12mm (Avdel Hemlok)	VFSH05-0008	22
15	Screw - M8 x 30	VFSH01-0014	2
16	Rivnut - M6x6x15.5 Flanged	VFSH06-0002	2
17	Screw and washer assy - M6x22 (Ø20 washer) Chem black	VFSH01-0022	4
18	Rivet - 4.8 x 12mm (Avdel Hemlok)	VFSH05-0005	4
19	M6 x 25 Socket button head screw black	VFSH01-0034	16
20	Washer M6 Normal heavy, form A Black	VFSH03-0028	16
21	Loop - Load Lashing LH - AC only	VFS01-16-086A	1

Seating & Associate Parts

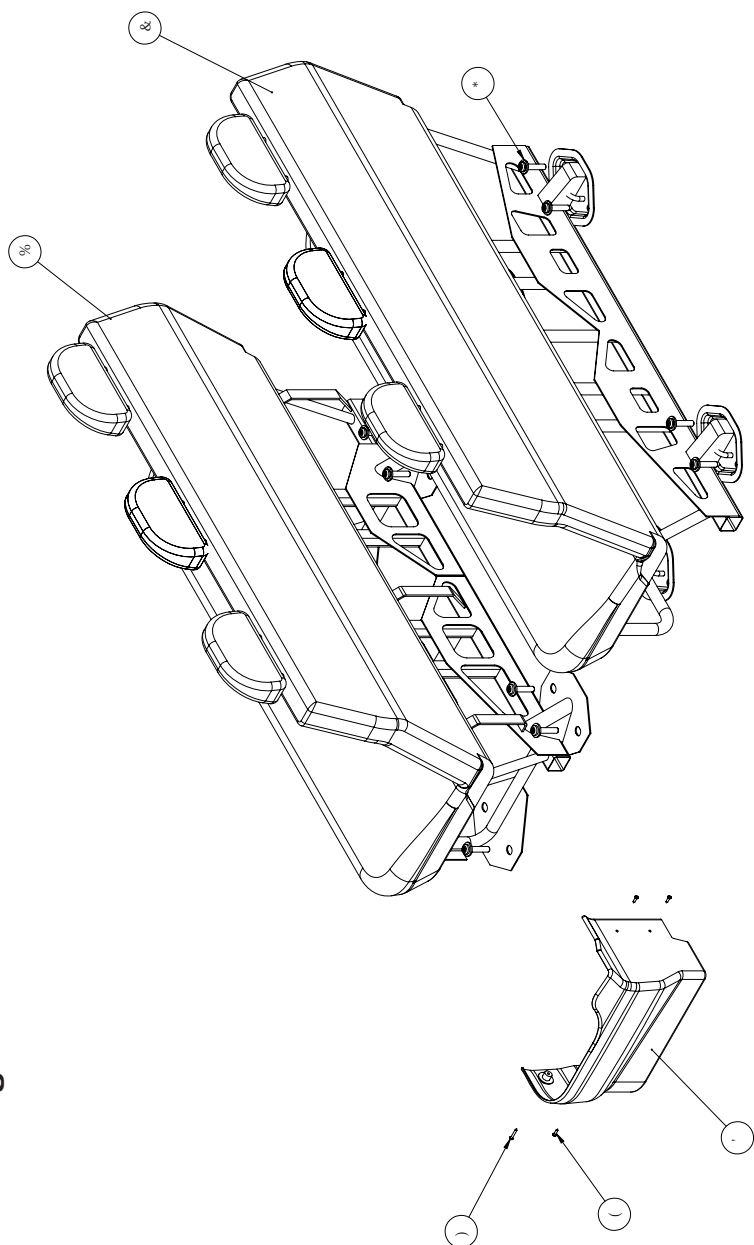

Spare Parts

ITEM	DESCRIPTION	PART NUMBER	QTY
1	Seat assy - Triple midi 2nd row	Ford Part	1
2	Seat assy - RHD Triple 3rd row	Ford Part	1
3	LH seat shield - Triple midi LHD	VFS01-16-041A	1
4	Screw self tapping 4.8 x 19mm - Pozi pan head Black	VFSH01-0026	3
5	Screw self tapping 4.8 x 32mm - Pozi pan head Black	VFSH01-0018	1
6	Screw and washer assy - M14x65 (Ø35 washer) Chem black	Ford Part	16

Spare Parts

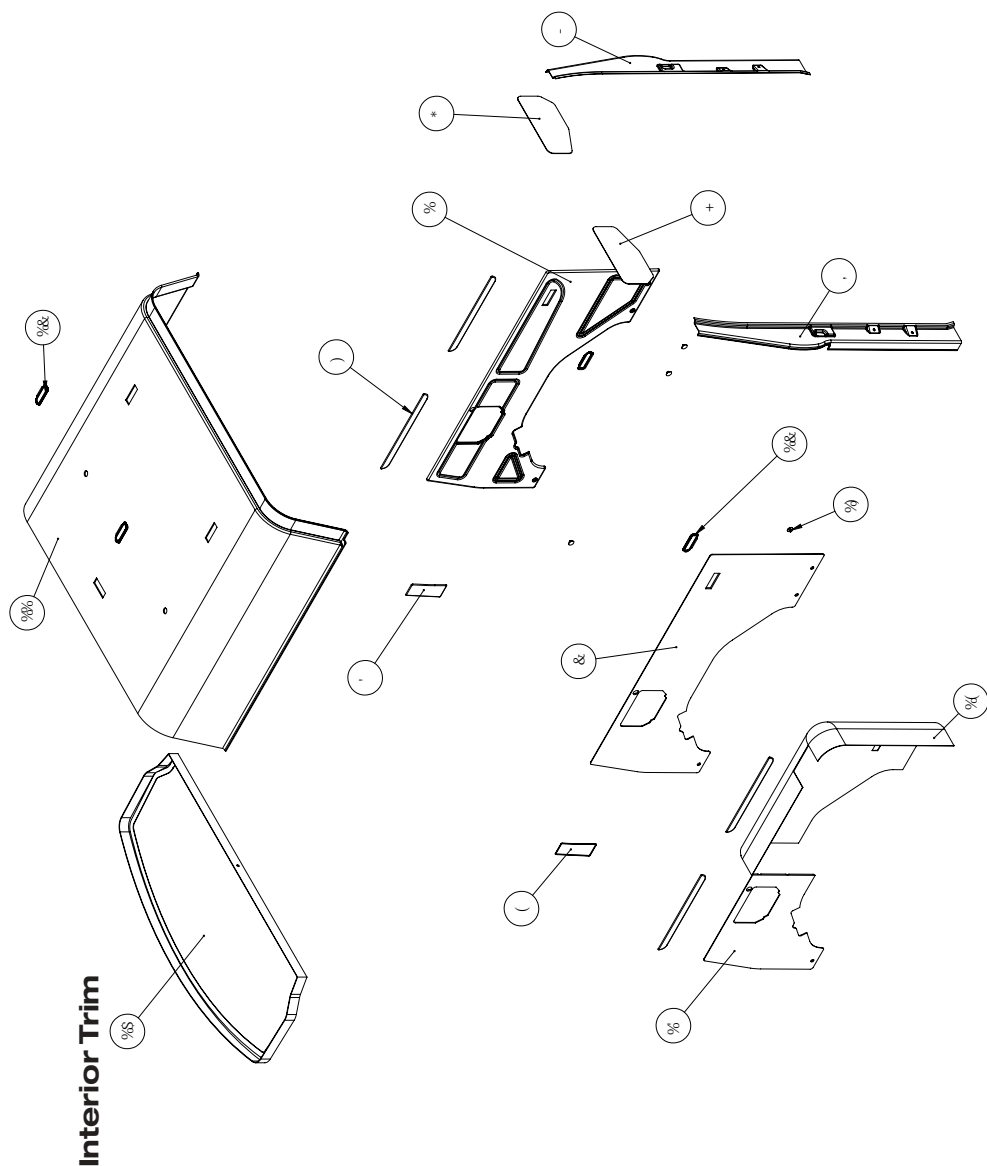

Spare Parts

ITEM	DESCRIPTION	PART NUMBER	QTY
1	Panel trimboard RHS, With speaker cutout	VFS01-16-082A	1
2	Panel trimboard LHS (Less AC)	VFS01-16-083A	1
3	Finisher C pillar RH	VFS01-12-075A	1
4	Finisher C pillar LH	VFS01-12-076	1
5	Finisher Bodyside inner - lower	VFS01-12-064A	4
6	Finisher - Rear door upper RH	VFS01-12-065A	1
7	Finisher - Rear door upper LH	VFS01-12-066A	1
8	Finisher D pillar LH (Non AC only)	VFS01-12-071A	1
9	Finisher D pillar RH	VFS01-12-070A	1
10	Mat rubber - Cab locker inner	Ford Part	1
11	Headlining - Rear section with lamp holes	VFS01-16-085A	1
12	Bezel - Lamp assy rear compartment	VFSL02-135008-150	4
13	Panel trimboard LHS (With AC)	VFS01-16-084A	1
14	Cover assy - HVAC with lamp hole	VFS01-16-051A	1
15	Clip trim board retainer - Short	Ford Part	6

Spare Parts

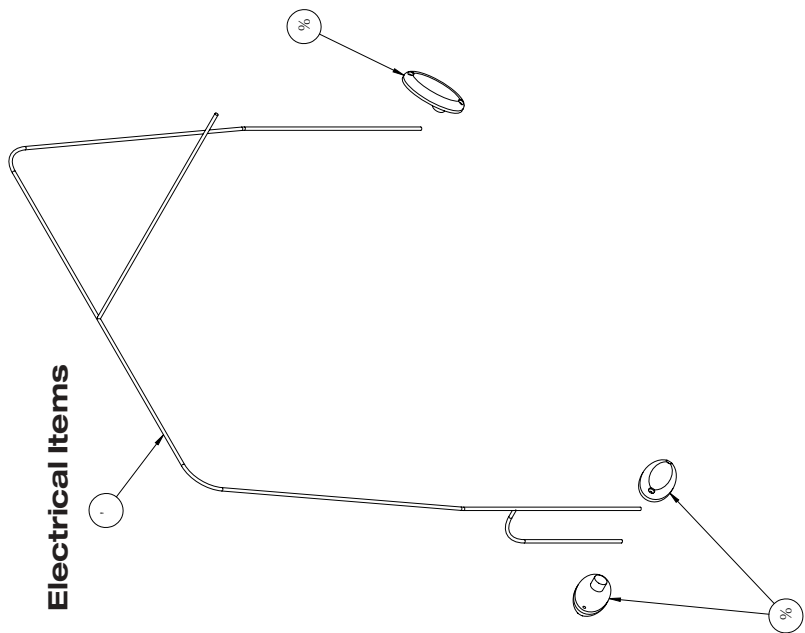
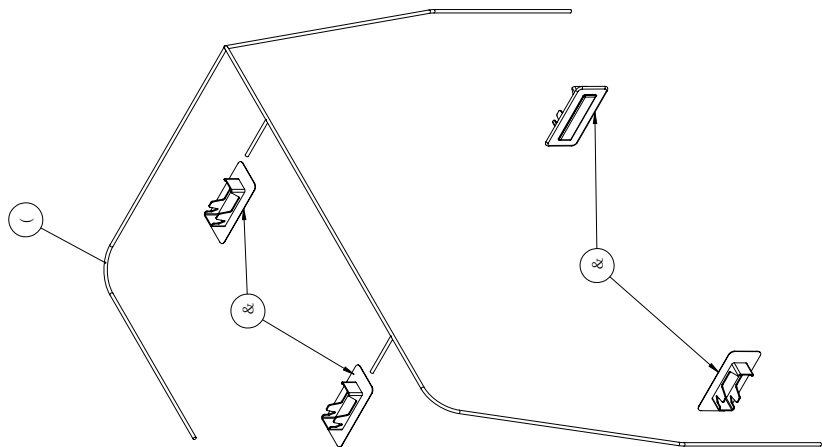

Electrical Items

[illegible]

37

Spare Parts

ITEM	DESCRIPTION	PART NUMBER	QTY
1	HANDLE ASSIST- 'C' PILLAR	VFS01-12-043A	1
2	HANDLE ASSIST - 'B' PILLAR LH	VFS01-12-100B	1
3	Support fire extinguisher fix	VFS01-12-032A	1
4	Extinguisher assy - Fire	VFS01-12-047A	1
5	PLATE - DECAL MOUNTING ASSY - FIRST AID / FIRE EXTINGUISHER	VFS01-12-095A	1
6	Bracket - First aid mounting	VFS01-16-020B	1
7	First aid kit	VFS01-12-046A	1
8	Rivnut - M6x9x15.5 Half-hex flanged	VFSH06-0009	5
9	Screw and washer assy - M6x22 (Ø20 washer) Chem black	VFSH01-0022	5
10	Rivnut - M8x11x17 Dome head	VFSH06-0008	1
11	Screw - M8 x 30	VFSH01-0014	2
12	M8 x 20mm x 1mm (Special) - Black	VFSH03-0008	3
13	Nut - M8 Flanged Locking Grade 8.8 - Chem Black	VFSH04-0009	1
14	Screw self tapping 4.8 x 16mm - Pozi pan head Black	VFSH01-0017	3
15	Screw - M5 x 16mm Domed Cross Head - Plated	VFSH01-0006	1
16	Washer M5 repair	VFSH03-0009	1
17	Rivet - 4.8 x 16mm - Steel (Small head)	VFSH05-0009	4
18	Decal Kit 9 seat Minibus	As below	1
	Decal - 'NO STANDING'	VFS01-12-077A	1
	Decal - 'PULL TO OPEN' (Left arrow)	VFS01-12-081A	2
	Decal - 'PULL TO OPEN' (Right arrow)	VFS01-12-082A	2
	Decal - 'LOCK/UNLOCK' (L)	VFS01-12-085A	1
	Decal - 'LOCK/UNLOCK' (R)	VFS01-12-086A	1
	Decal - 'Converters Name & Contact Details'	VFS01-12-088A	1
	Decal - 'FIRE EXTINGUISHER UNDER FRONT SEAT'	VFS01-12-097A	1
	Decal - 'SEATING CAPACITY 8 PASSENGERS'	VFS01-16-080A	1
	Decal - 'First aid in overhead locker/Fire extinguisher under front seat'	VFS01-16-081A	1
	Decal - 'First aid kit in overhead locker'	VFS100-057	3
	Decal - 'PULL RELEASE STRAPS'	VFS100-058	1
	Decal - 'STOW HEAVY LUGGAGE'	VFS100-059	1

Warranty

The base vehicle is protected by a 3-year/100,000 mile warranty by Ford Motor Company under the standard conditions of warranty for Transit. The additional vehicle equipment, supplied and fitted by VFS Ltd are covered under a separate 3-year/100,000 mile warranty offered by VFS Ltd.

Upgrades are available for the base vehicle, giving an option of scheduled servicing for up to 4 years. Upgrades are not available for the additional content supplied by VFS Ltd.

Warranty claims for the additional content supplied by VFS Ltd, detailed in the parts list section of this handbook should be made direct to VFS Ltd.

Contact details:-

VFS (Southampton) Ltd.

Unit 8

Barton Park Industrial Estate

Chickenhall Lane

Eastleigh

Hants

SO50 6RR

Tel: 023 8065 1704

Fax: 023 8062 0999

E-mail: parts@vfs.co.uk

Index

	Description	Page
A	Air conditioning	16
	Alarm	12
B	Bulb replacement	15
C	Child safety	7
	Climate control	16
D	Doors	6
	Decals	23
	Dimensions	26
E	Emergency equipment	22
F	Fire extinguisher	22
	First aid kit	22
H	Handles	9
I	Introduction	3
	ISO Fix	7
	Identification numbers	25
	Interior lighting	15
L	Legal requirements	4
	Locks	8
	Locking feedback	10
	Lighting	14
	Luggage	21
	Luggage illumination	15, 27

Index

	Description	Page
M	Maintenance	24
	Maintenance & repair log	42
O	Occupant protection	7
P	Parts	29 to 38
R	Roof rack	6
	Remote control	8
S	Symbols	3
	Seating	5, 7, 19
	Seatbelts	7
	Stepwell illumination	14, 28
	Specifications	26
	Spare parts	29 to 38
T	Tachograph	4
	Tyres / Tyre pressures	26
	Technical specification	26
V	Vehicle layout	5
	Vehicle identification	25
W	Warning instructions	21
	Warning decals	23
	Warranty	39
	Wiring diagrams	27, 28

Maintenance & Repair Log

This Log is intended to keep a record of all maintenance and repair actions carried out on the parts and equipment detail within the parts section of this handbook.

Date

Mileage

Service Agent/Repairer:

Maintenance/Repair action

Maintenance & Repair Log

Date

Mileage

Service Agent/Repairer:

Maintenance/Repair action

Date

Mileage

Service Agent/Repairer:

Maintenance/Repair action

Maintenance & Repair Log

Date

Mileage

Service Agent/Repairer:

Maintenance/Repair action

Date

Mileage

Service Agent/Repairer:

Maintenance/Repair action

Maintenance & Repair Log

Date

Mileage

Service Agent/Repairer:

Maintenance/Repair action

Date

Mileage

Service Agent/Repairer:

Maintenance/Repair action